

# The Syracuse Creekwalk

*Green Infrastructure in the Urban Core*

**Mike Gridley, RLA, ASLA, Senior Landscape Architect**





# Planning Context - Background

- 1910 – USACOE, Flood Prevention Program
- 1964 - Jim Heath, Parks Commissioner
  - Vision: Trail along Onondaga Creek from Nedrow to Onondaga Lake
- Early 1990's – Original studies for overall Creekwalk
- Early to mid 1990's – Franklin Square and Inner Harbor segments completed.
- 2000 – Start of Creekwalk from Armory Square to Onondaga Lake

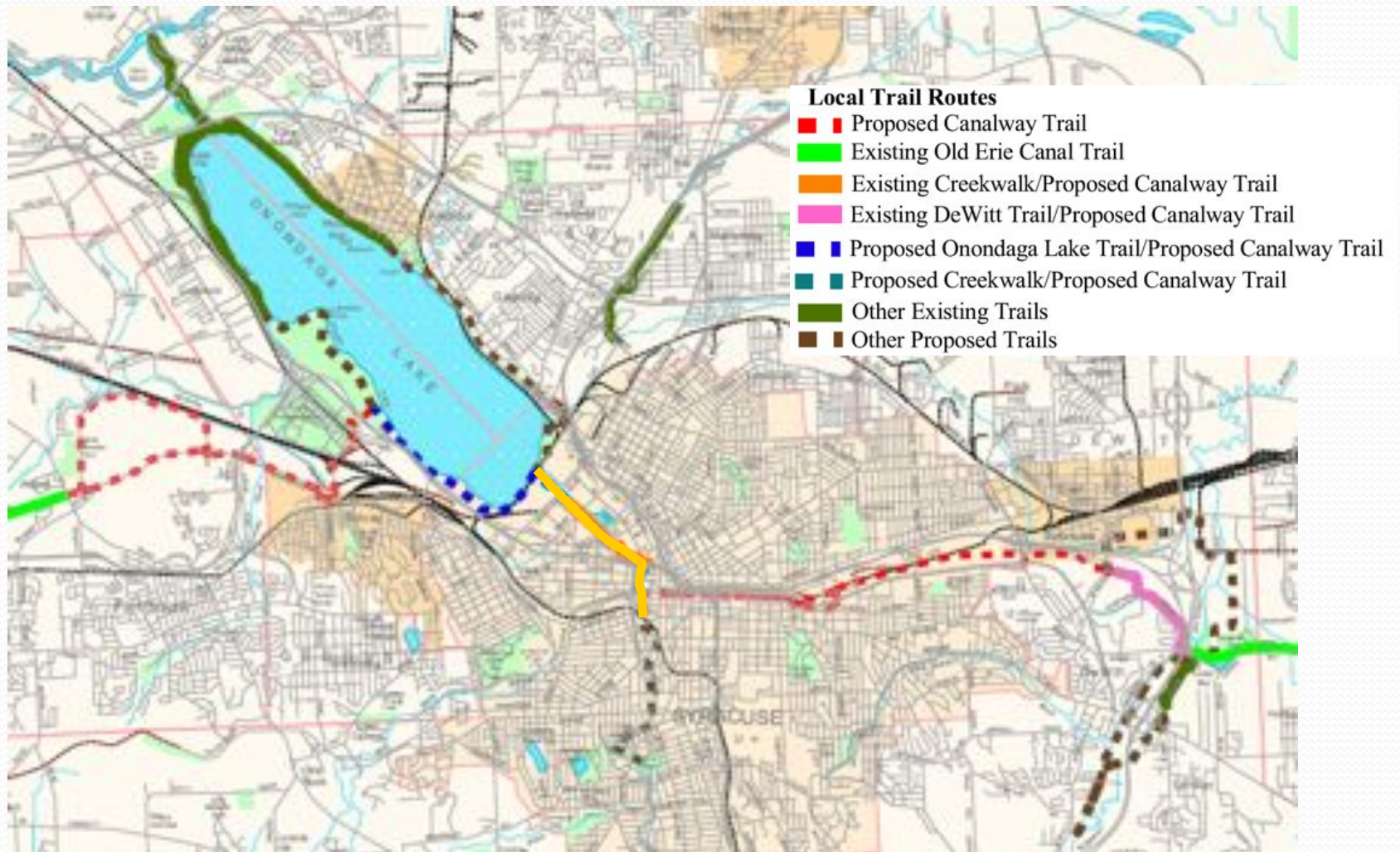

- Comprehensive plan



# Final Alignment

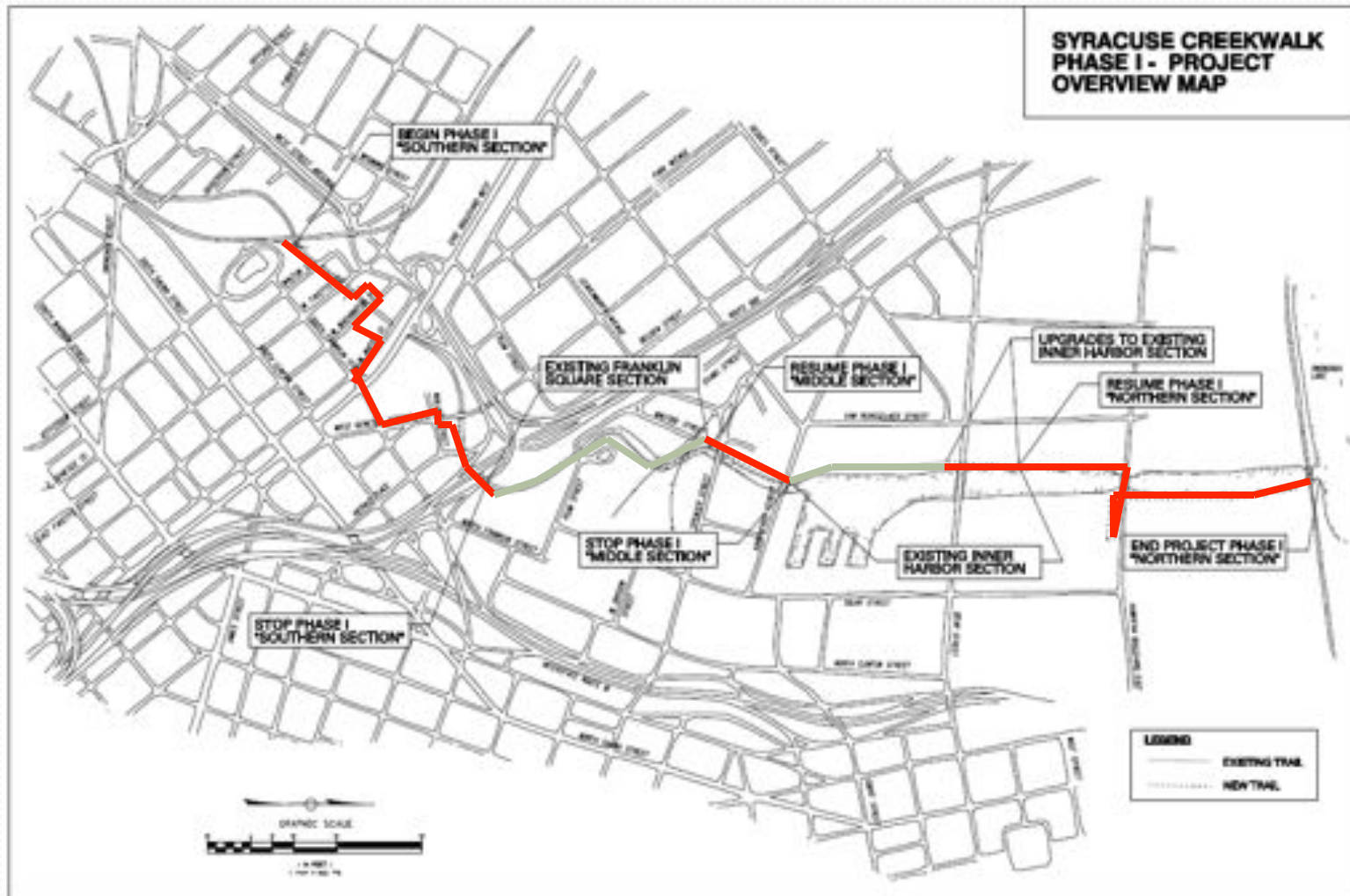

# Final Alignment – Southern Section

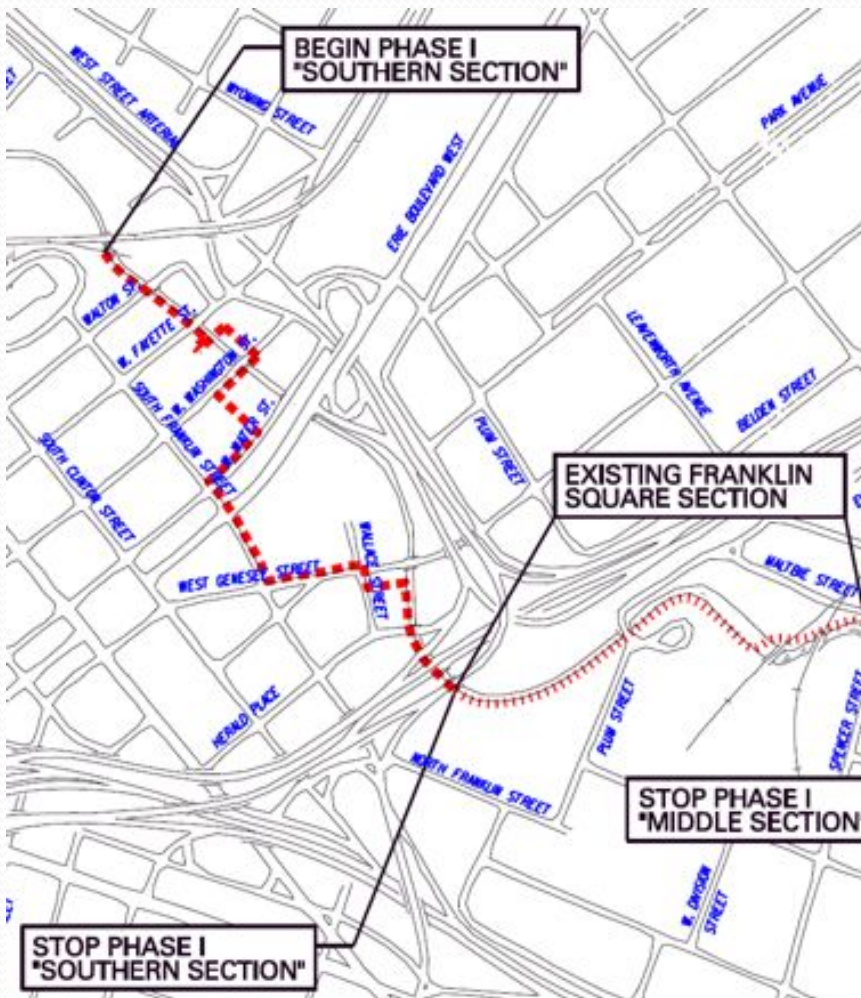

- Starts at MOST
- Washington to W. Geneesee – obstructions force street use
- Utilize bank near Wallace to transition

# Final Alignment – Middle and Northern Sections

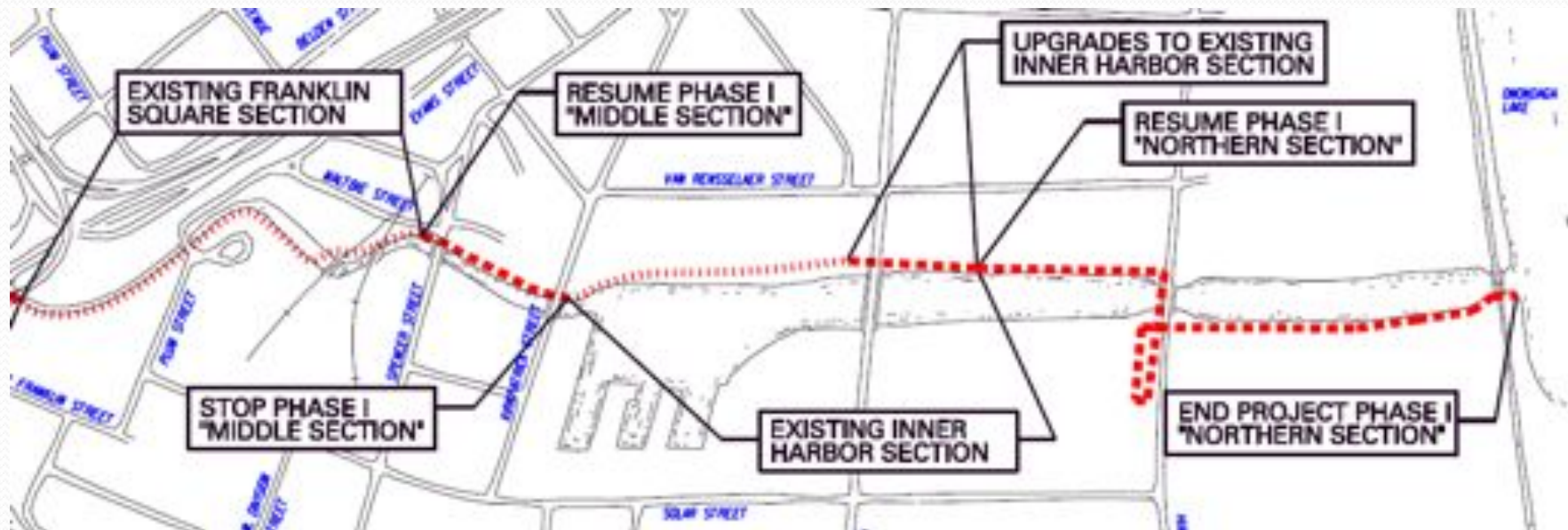

- Franklin Square and North – parallel Creek with exception of Parks Department
- Utilize existing Inner Harbor path



# Construction

- West Jefferson to Fayette Street
- Gateway to Creekwalk



# Green Infrastructure

- West Jefferson to Fayette Street
- Porous pavement provides supplemental storage and gradual release of water

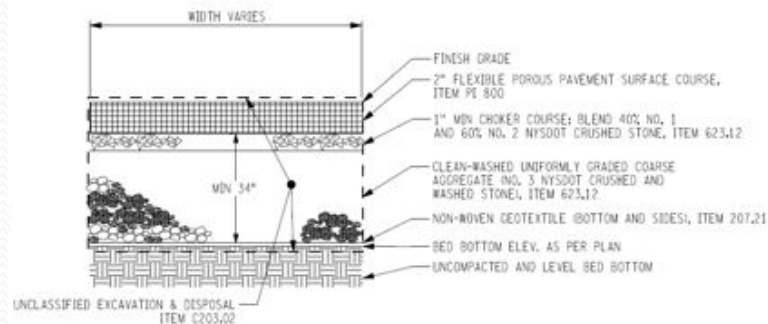

TYPICAL SECTION K  
FLEXIBLE POROUS PAVEMENT BED SECTION  
N.T.S.

STA. 0+25.00 TO STA. 0+75.00

NOTES:

1. CONTRACTOR SHALL FOLLOW CONTROL REQUIREMENTS AS DESCRIBED IN WRITTEN TECHNICAL SPECIFICATIONS AND AS DIRECTED BY ENGINEER.
2. PLACEMENT OF CLEAN AGGREGATE FOR INFILTRATION BED TO BE APPROVED BY ENGINEER.







POROUS  
ASPHALT

FLEXIPAVE



FLEXIPAVE



# Green Infrastructure

- West Jefferson to Fayette Street
- Design detail shifts water storage away from existing buildings

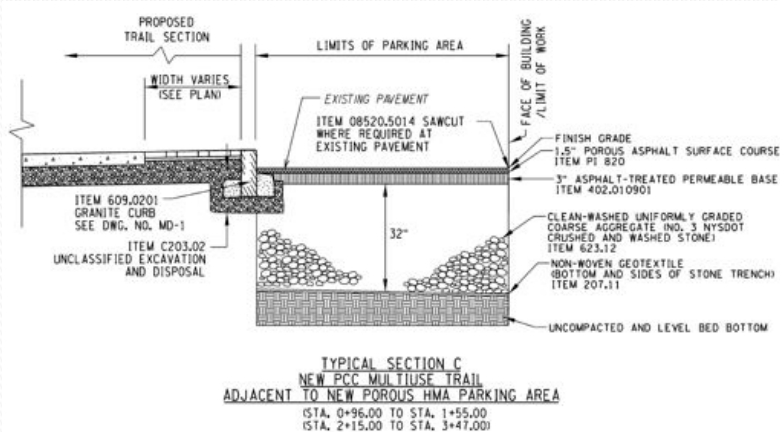



# Green Infrastructure

- Alternate detail - continued



# Green Infrastructure

- Alternate detail - continued



# Green Infrastructure

- Alternate detail - continued





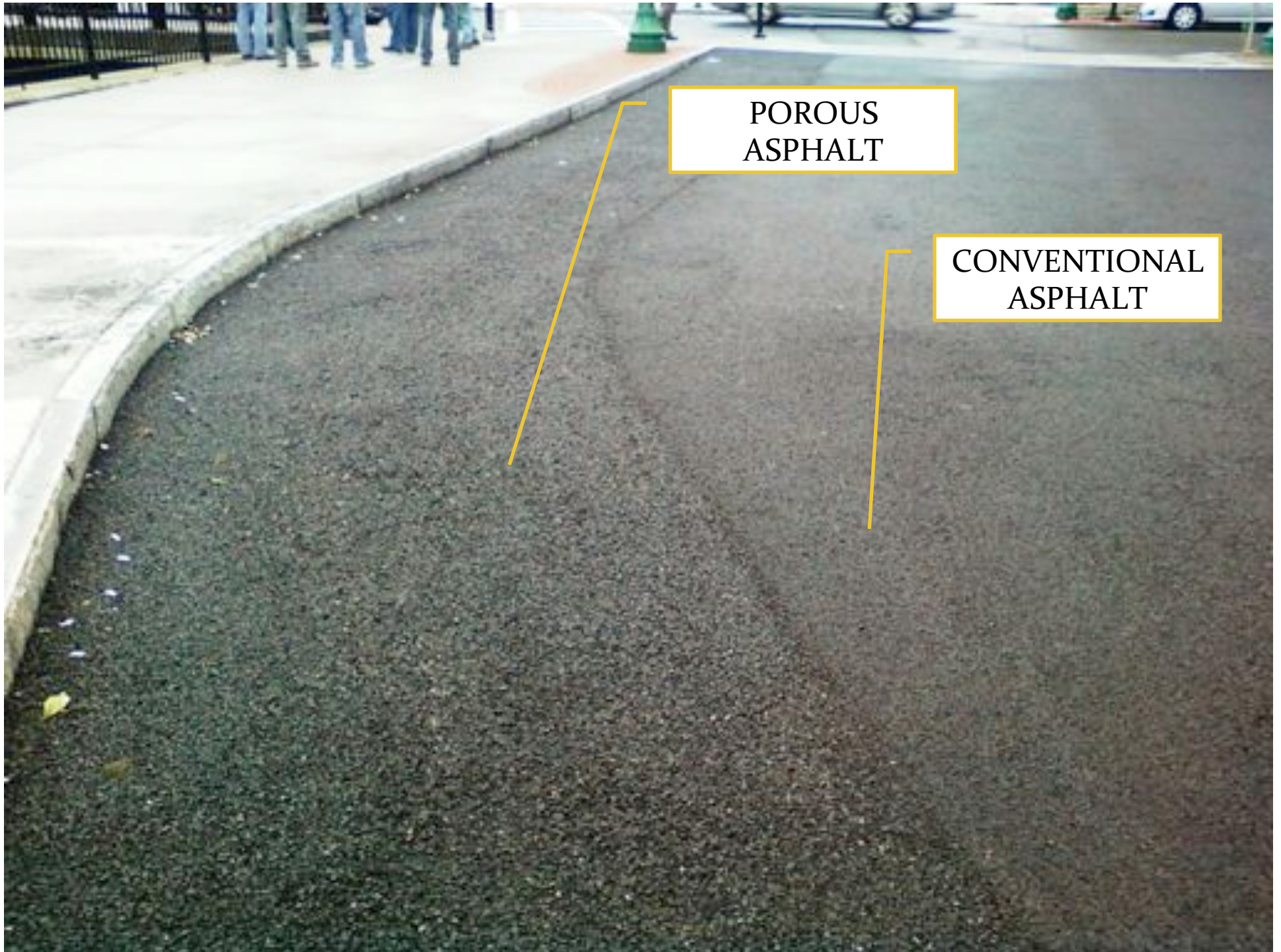

POROUS  
ASPHALT

CONVENTIONAL  
ASPHALT





POROUS  
ASPHALT

CONVENTIONAL  
ASPHALT

# Green Infrastructure

- West Jefferson to Fayette Street
- Porous concrete

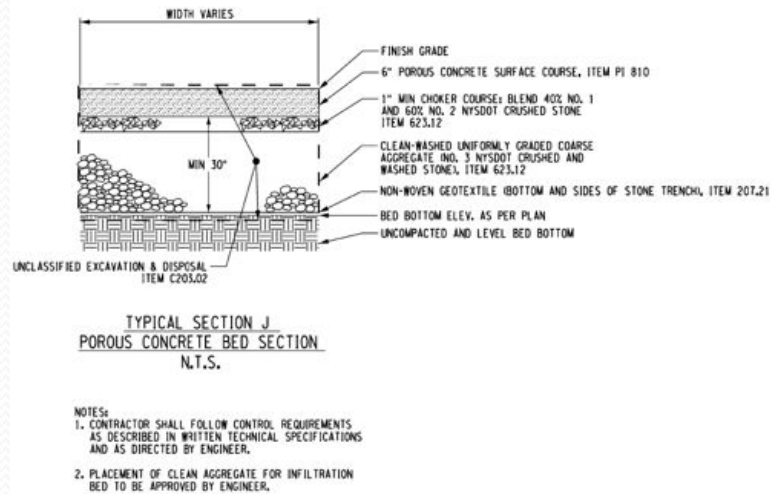





POROUS  
CONCRETE

CONVENTIONAL  
CONCRETE

# Green Infrastructure

- Rain garden









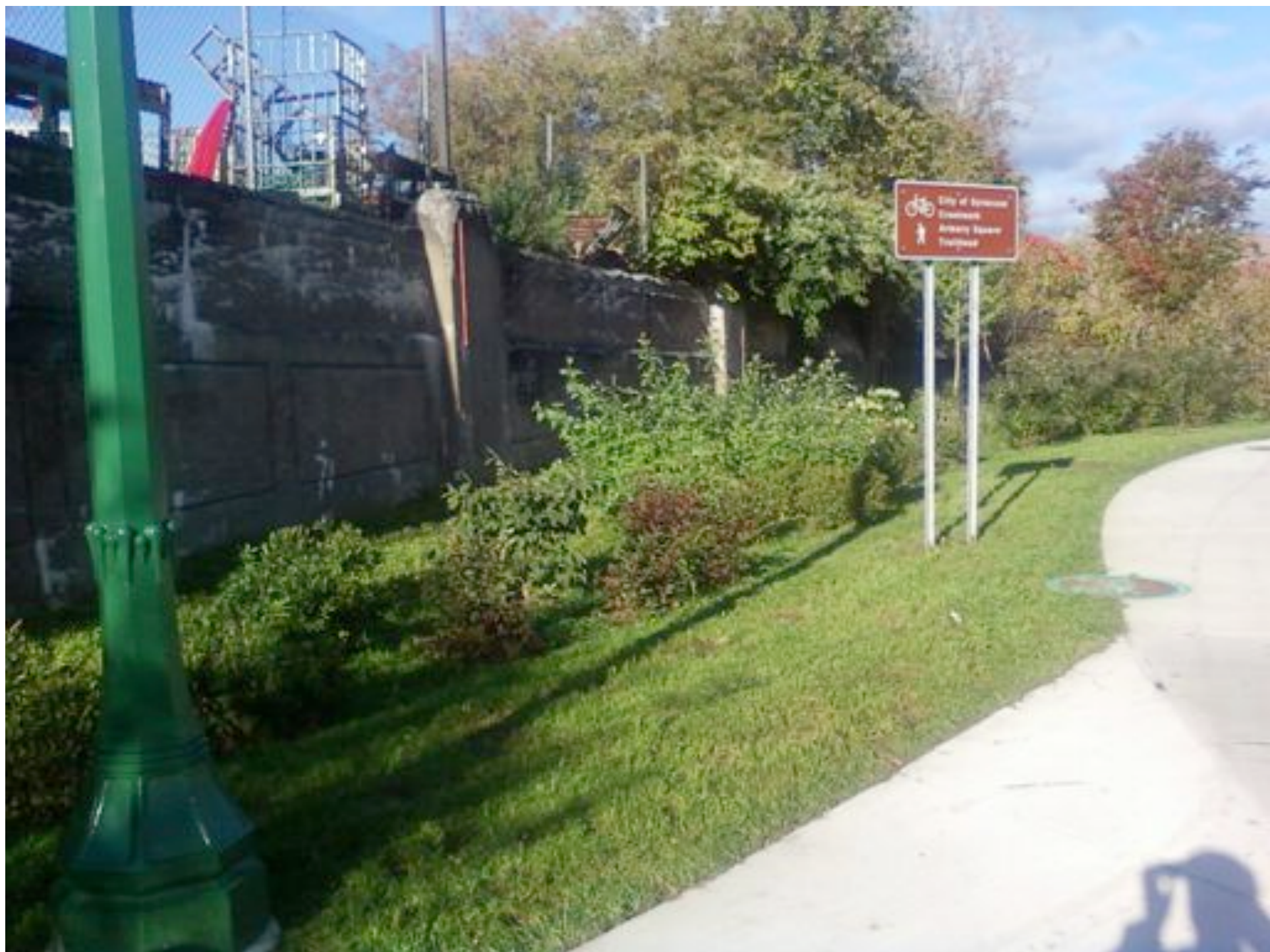

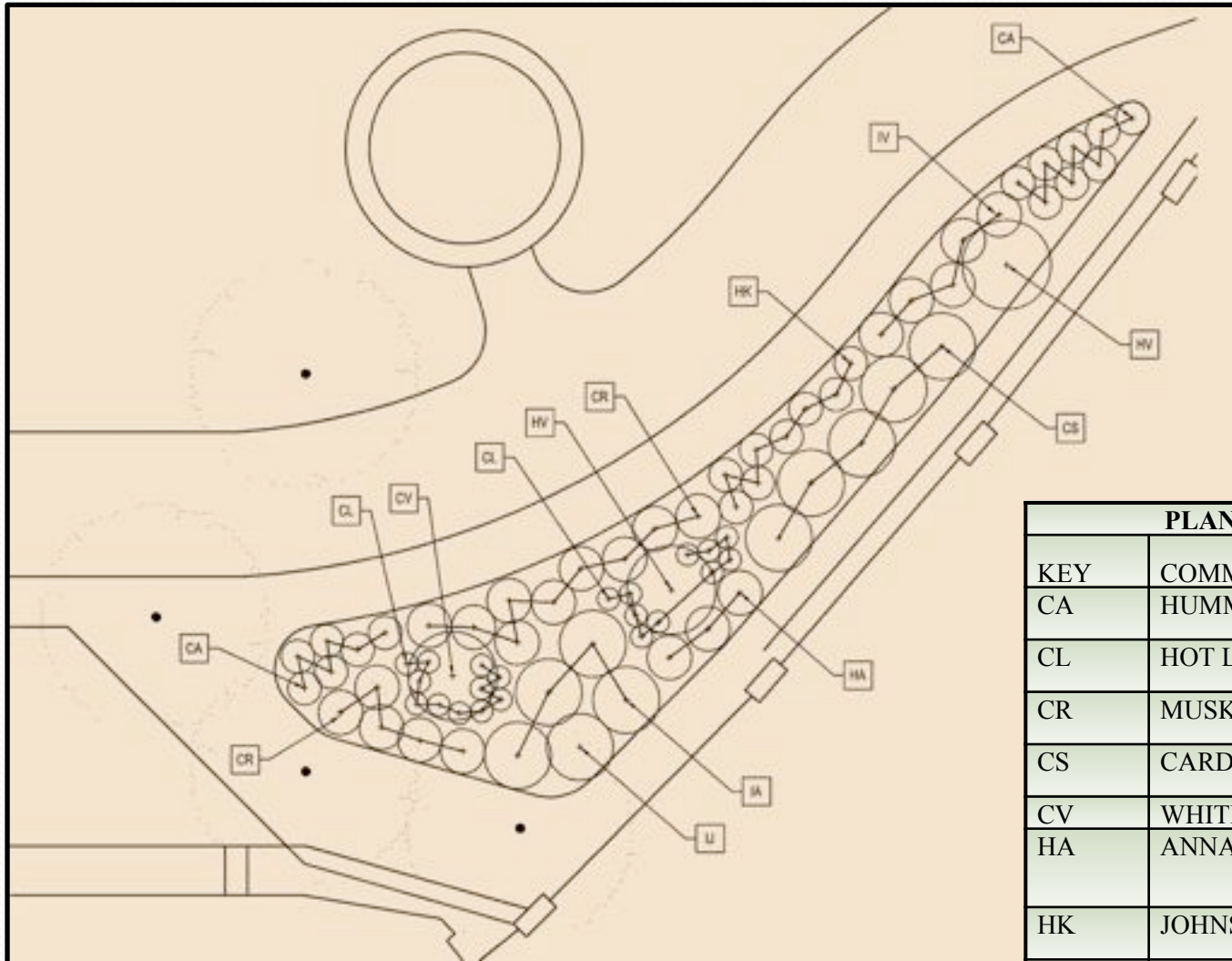

PLANT MATERIAL TABLE	
KEY	COMMON NAME
CA	HUMMINGBIRD SWEET PEPPERBUSH
CL	HOT LIPS TURTLEHEAD
CR	MUSKINGUM GRAY DOGWOOD
CS	CARDINAL REDOSIER DOGWOOD
CV	WHITE FRINGETREE
HA	ANNABELLE SMOOTH HYDRANGEA
HK	JOHNSWORT
HV	COMMON WITCHHAZEL
IA	AFTERGLOW WINTERBERRY (FEMALE)
IJ	JIM DANDY WINTERBERRY (MALE)
IV	LITTLE HENRY SWEETSPIRE





OVERFLOW  
RISER

# Green Infrastructure

- Tree protection and preservation





ELEVATED  
SIDEWALK GRADE

ENHANCED OPEN  
AREA

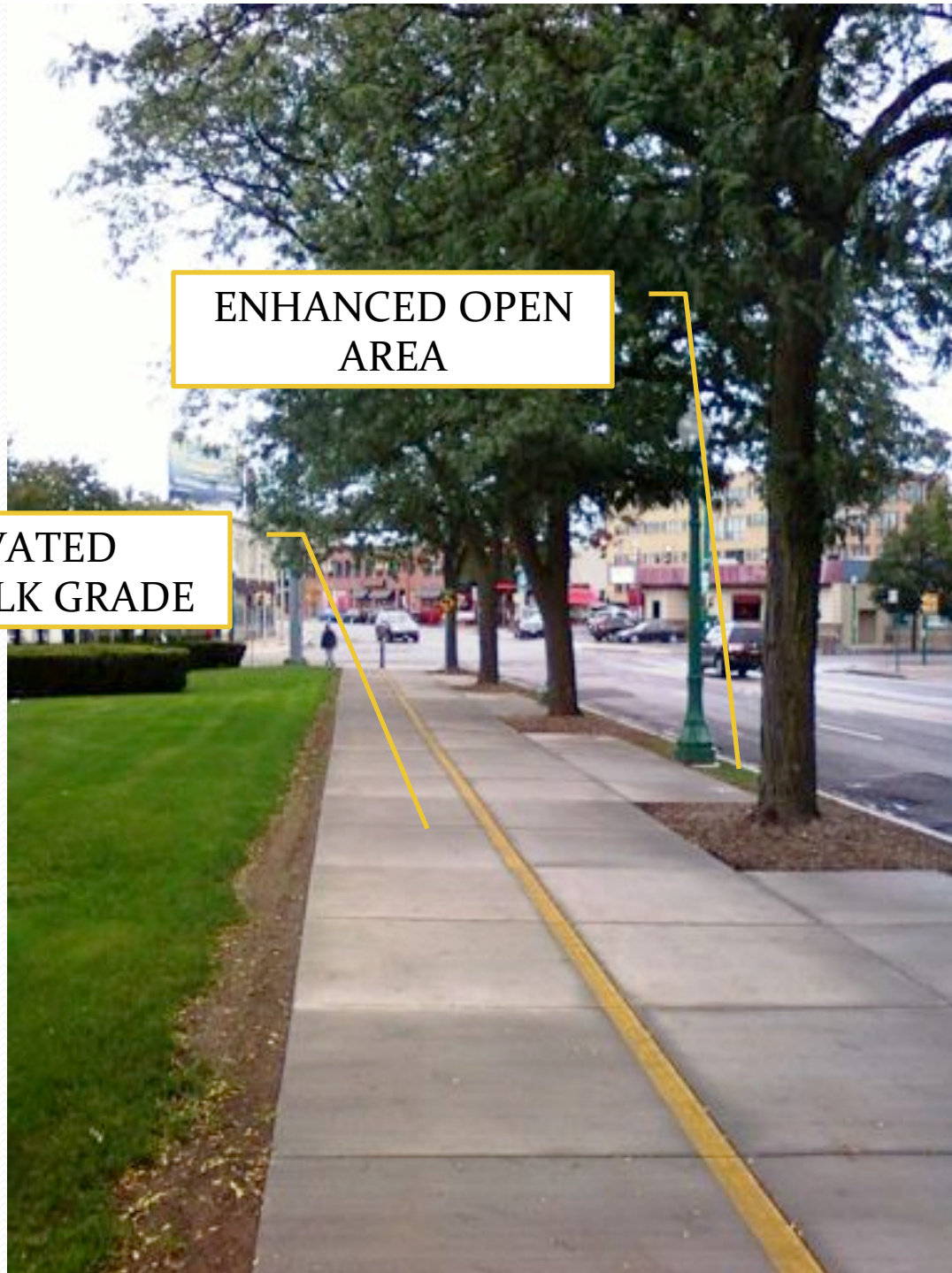



ENHANCED OPEN  
AREA

ELEVATED  
SIDEWALK GRADE



- Structural Soils (CU-Soil)

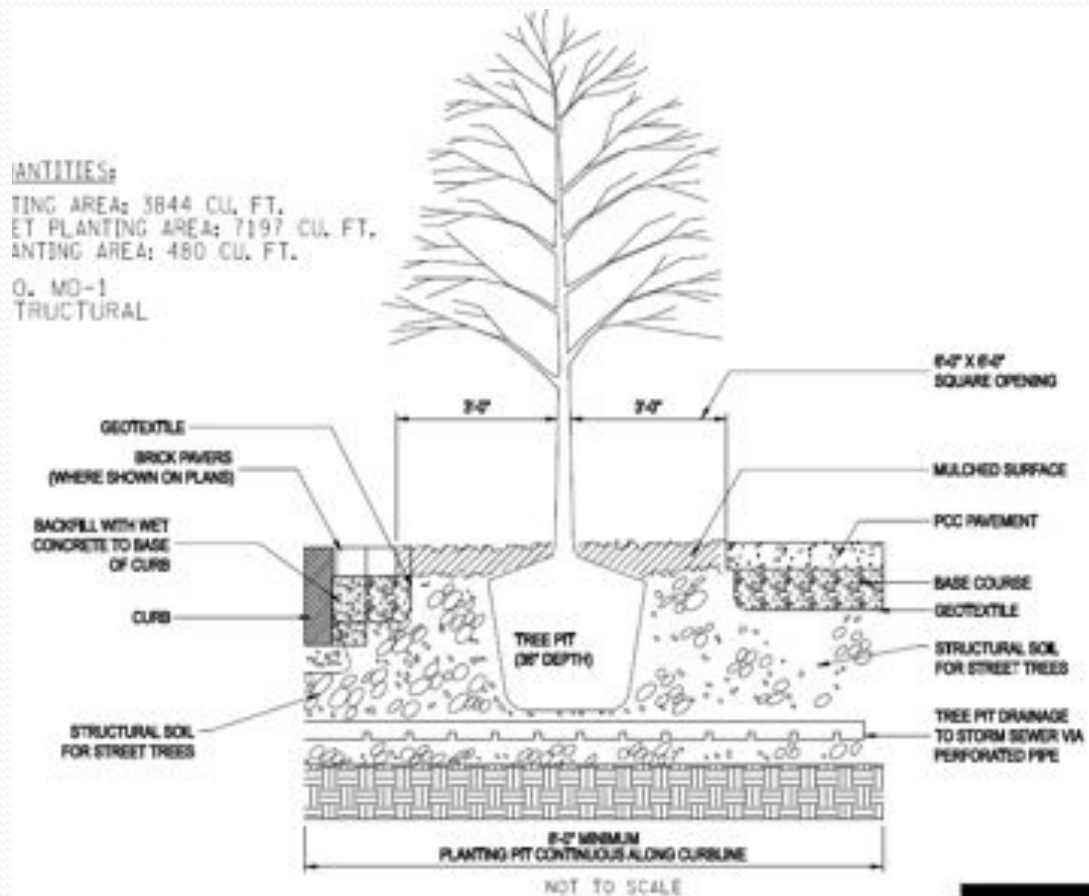

STRUCTURAL SOIL  
BREAKOUT ZONE





STRUCTURAL SOIL  
BREAKOUT ZONE





# Construction

- Contractor: M.A. Bongiovanni, Inc.
- Construction Cost: \$6.75 Million
- Completed: Fall 2011



# Questions?



**C&S**  
COMPANIES®